

Learning from the Existing: Spa Settlements as a Pedagogical Framework for Environmentally Sensitive Spatial Futures

Aleksandra Milovanović, Mladen Pešić, Jelena Ristić Trajković,
Milica Milojević, Verica Krstić, Ana Nikezić, Vladan Đokić

University of Belgrade – Faculty of Architecture, Laboratory for Urban Morphology and Typology (Morpho-Lab)

Funding

This research was supported by the Science Fund of the Republic of Serbia, Grant No. 7408, Future Heritage of Spa Settlements: Digital Platform for Advancing Knowledge and Innovation in Urban Morphology Approach for Environmentally Sensitive Development in Serbia—SPATTERN (<https://spattern.org/>).

value shift in design education
*learning from the **existing***
***no-demolish** pedagogies*
*regenerative and **care-based futures***

CONCEPTUALIZATION

ANTICIPATION

design and development of environmentally sensitive design pedagogies

testing and comparing environmentally sensitive design pedagogies

heritage-driven curricula
re-strategies
methodological frameworks

observatory framework
spascapes as pedagogical laboratories
future-oriented heritage

HERSUS.
Enhancing of Heritage Awareness and Sustainability of Built Environment in Architectural and Urban Design Higher Education

SPATTERN.
Future Heritage of Spa Settlements: Digital Platform for Advancing Knowledge and Innovation in Urban Morphology Approach for Environmentally-Sensitive Development in Serbia



HERSUS

2020-2023



2023-2026

continuity in pedagogical innovation



IO-1 Review

Best Practices on Educating Sustainability and Heritage



built projects
pedagogical models
policy framework

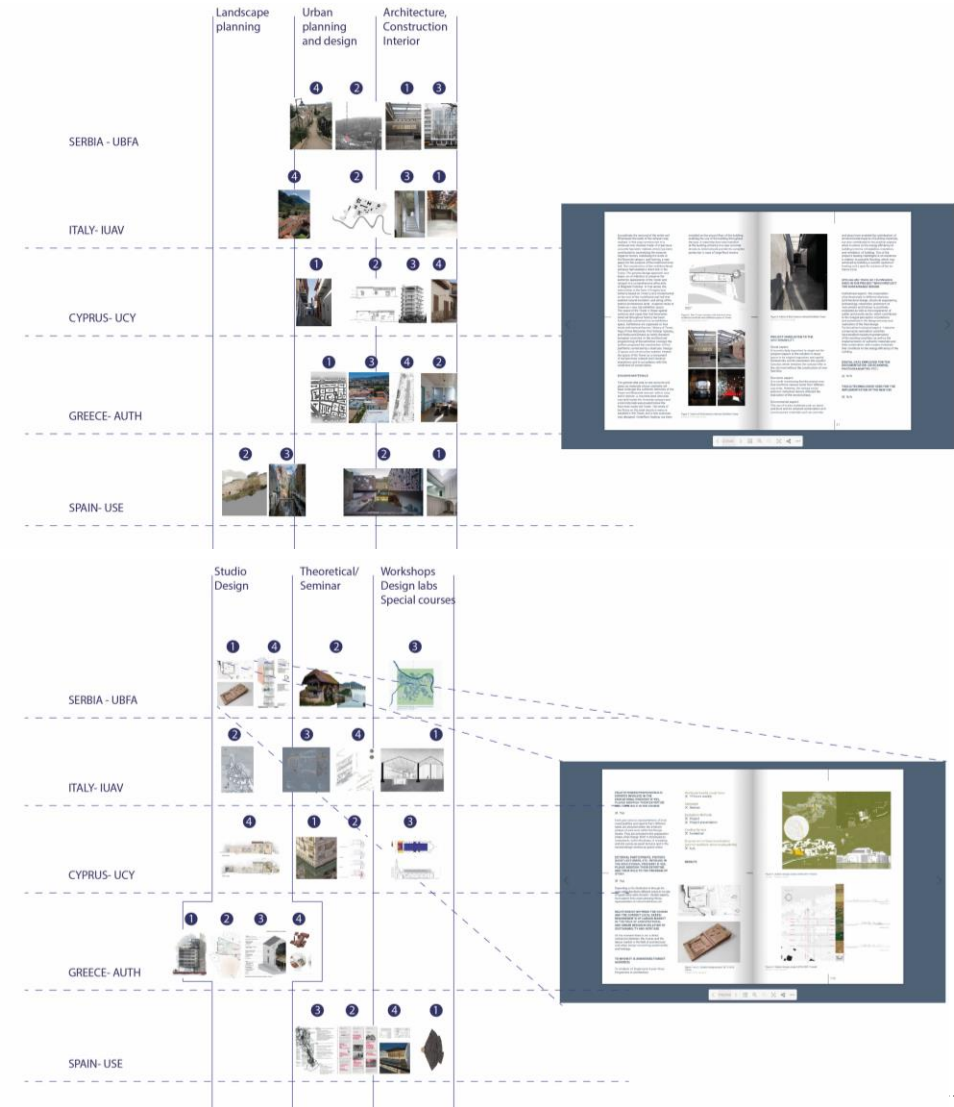
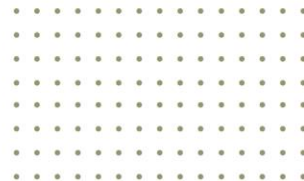

IO-2

Study

Questionnaire for the State-of-the-art

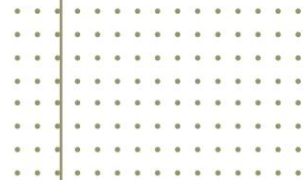

skills
competences
employability

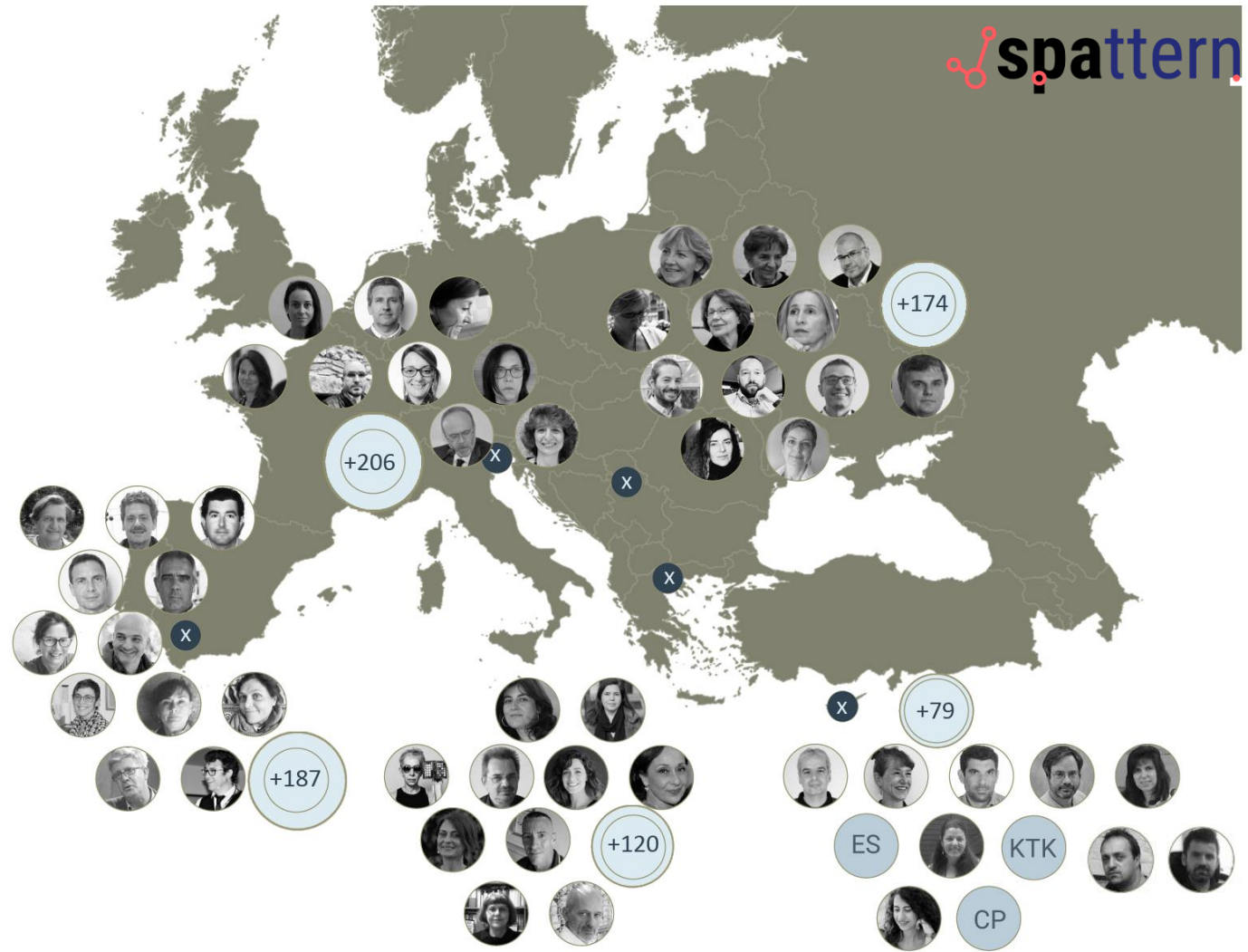

IO-3 Statements

for Teaching through Design for Sustainability of the Built Environment and Heritage Awareness



notions
heritage types
design approaches
design actions
design tools

HOW TO READ HERSUS VADEMECUM STATEMENTS

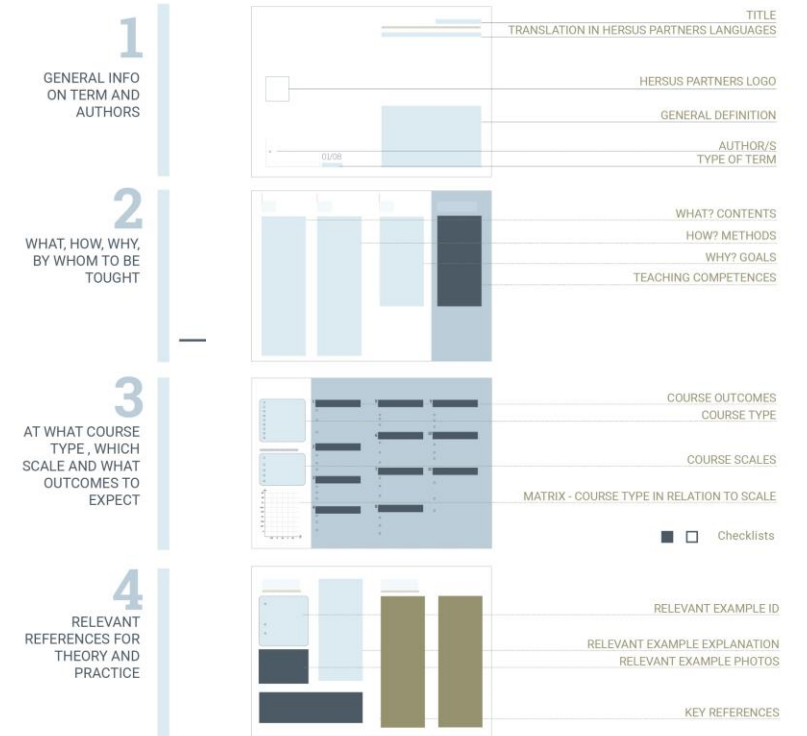

IO-4 Sharing Platform hersus-sharingplatform.org



digital tool
georeferencing
repository
tag matrix

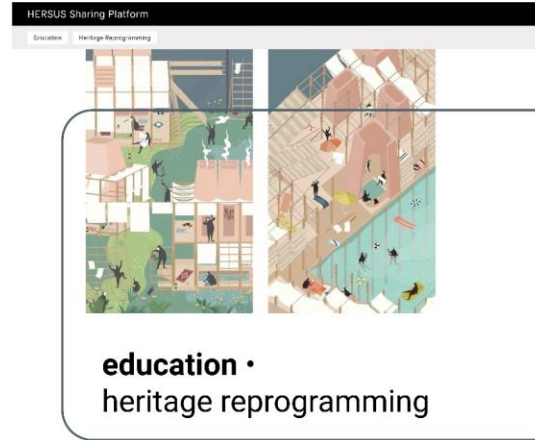

education •
heritage reprogramming

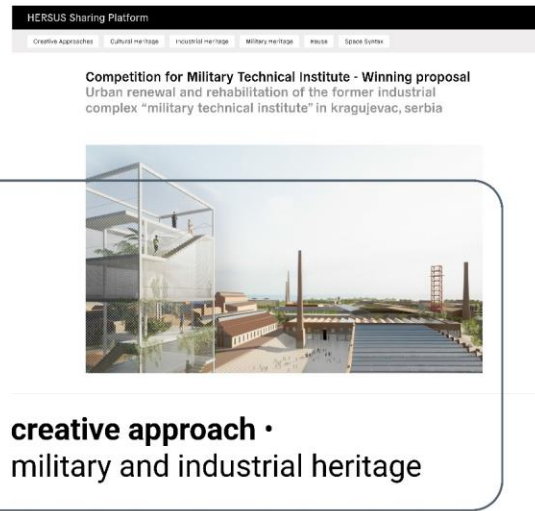

creative approach •
military and industrial heritage

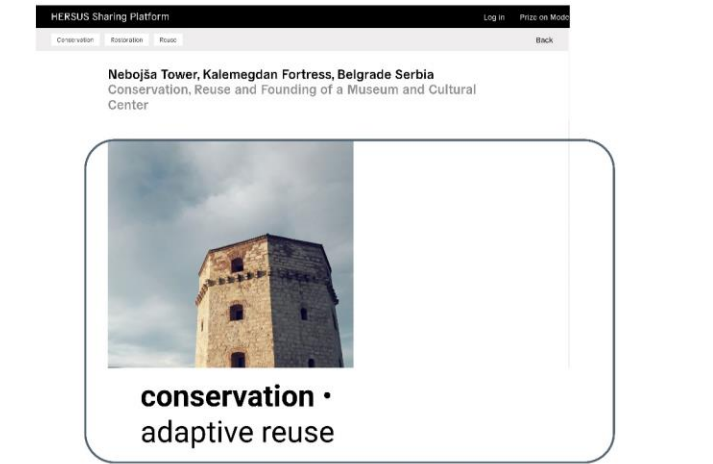
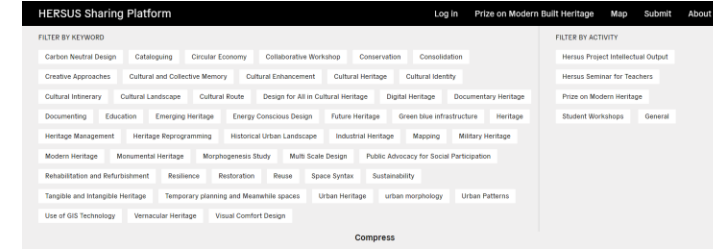

conservation •
adaptive reuse



IO-5

Book of Courses

Imagining Program for Sustainability of the Built Environment and Heritage Awareness



fundamentals
electives
design studio
workshops



— preparation phase
— expert group meetings
- - post-expert groups meeting

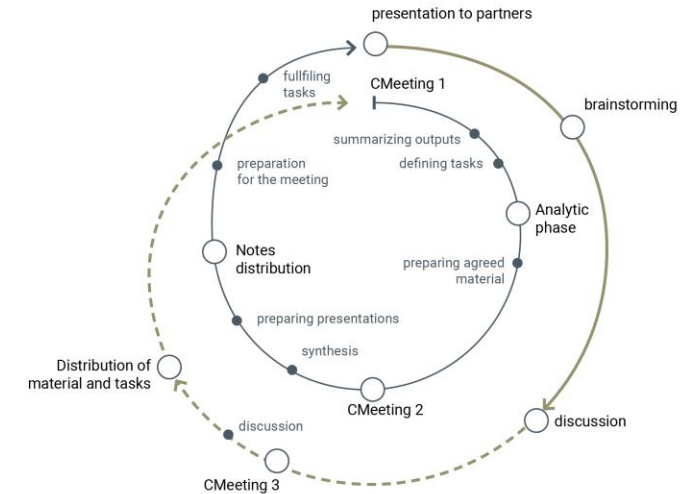

FIRST SEMESTER: linking heritage and sustainability	+
SECOND SEMESTER: linking heritage, sustainability, and people	+
THIRD SEMESTER: linking heritage, sustainability, people and environment	+
FOURTH SEMESTER : Master thesis project	+







IO-6 International Handbook on Research and Design for the Sustainable Heritage



education
practice
research

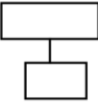

Conceptualization

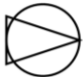
	Approach	Core Idea	Key Methods	Outcomes	Values
	HERITAGE REPROGRAMMING DESIGN APPROACH	Heritage as a dynamic resource to be reprogrammed for contemporary uses without demolition	Critical mapping, adaptive reuse, scenario design	New programmatic typologies rooted in inherited structures	Circularity, care for the existing, long-term adaptability
	MULTISENSORY DESIGN	Engaging all senses to design spaces that support well-being and embodied experience	Sensory mapping, behavioral observation, narrative design	Inclusive design solutions that address more-than-visual perception	Inclusivity and empathy, human-centered design, well-being
	HEALTH PROMOTING DESIGN	Architecture and urban design as active agents for health and preventive care	Environmental diagnostics, health-impact assessment, restorative landscape design	Integration of health infrastructure into urban form	Care and prevention, public good, integration of health and space
	HYBRID NATURALITIES DESIGN APPROACH	Exploring the “third nature” – hybrid of natural and cultural flows in Anthropocene ecologies	Site eco-diagnostics, ecological storytelling, speculative programming	Hybrid landscapes that merge heritage, ecology, and technology	Ecology – resilience symbiosis, coexistence of human and non-human agents
	CULTURE SENSITIVE DESIGN	Embedding cultural values and local identities into spatial design processes	Ethnographic observation, storytelling, contextual analysis	Place-specific typologies that preserve cultural identity while enabling adaptation	Diversity, rootedness, cultural sustainability
	SPECULATIVE HERITAGE DESIGN	Anticipating future heritage through critical and imaginative exploration of the present	Speculative mapping, visual narratives, research-by-design	Alternative visions of what might become heritage	Critical reflection, anticipation, openness to uncertainty

Anticipation

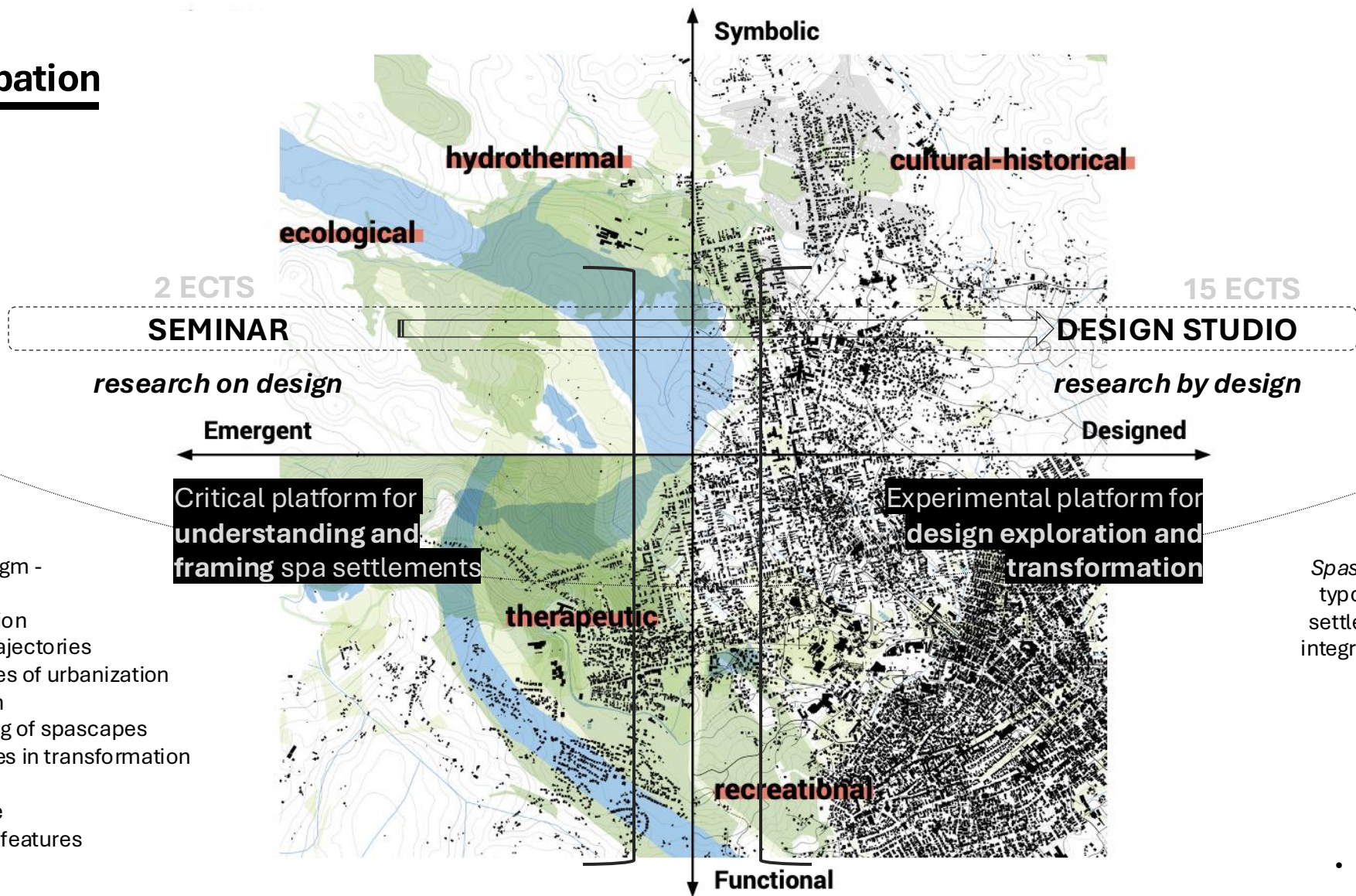

New urban theory paradigm - urban dimensions:

- Material transformation
 - Historical trajectories
 - Naturescapes of urbanization
- Territorial regulation
 - Programming of spascapes
 - Public spaces in transformation
- Living the spa
 - Everyday life
 - Therapeutic features

Spascapes are emergent spatial typologies characteristic of spa settlements, formed through the integrated interplay of six primary landscape types.

- hydrothermal,
 - therapeutic,
- cultural-historical,
 - urban,
 - ecological, and
- recreational landscapes.

Anticipation

Macro Scale – Territorial Landscape Healing Landscape	Geothermal isolation	Ornamental regularity	Lowland vastness	Ceremonial enclosure	Wilderness exposure	River margin	Territorial layering	Mountain encasement	Flat saline landscape	Encapsulated valley	Elevated wilderness	Regional anchoring
Meso Scale – Urban Framework Therapeutic Infrastructure	Enclave pattern	Park-based logic	Fragmented openness	Axial ritualism	Linear immersion	Dispersed wellness	Institutional cluster	Campus-based zoning	Minimal intervention	Dual structuring	Topographic fragmentation	Urban symmetry
Micro Scale – Ambient Setting Sensorial Spatial Unit	Humidity-infused stone	Archetype of spa	Mild topography	Fountain vapor	Tactile layering	Blue-green textures	Steam dominance	Shaded treatment zones	Open-air exposure	Hydro-thermal node	Organic healing points	Ceremonial typologies
Intimate Scale – Experiential Detail Individual Perception	Sensory detachment	Ambient lightness	Diffuse circulation	Structured calm	Thermal seclusion	Symbolic watercourses	Water plastic	Clinical calm	Elemental stillness	Everyday therapeutic ritual	Melancholic facility	Interior tranquility
01 Brestovačka banja	02 Bukovička banja	03 Banja Kanjiža	04 Banja Koviljača	05 Ruzumlijska banja	06 Matarska banja	07 Niška banja	08 Ribarska banja	09 Banja Ruzanda	10 Sokobanja	11 Vranjska banja	12 Vrnjačka banja	
Macro Scale – Territorial Landscape Healing Landscape	Geothermal isolation	Ornamental regularity	Lowland vastness	Ceremonial enclosure	Wilderness exposure	River margin	Territorial layering	Mountain encasement	Flat saline landscape	Encapsulated valley	Elevated wilderness	Regional anchoring
Meso Scale – Urban Framework Therapeutic Infrastructure	Enclave pattern	Park-based logic	Fragmented openness	Axial ritualism	Linear immersion	Dispersed wellness	Institutional cluster	Campus-based zoning	Minimal intervention	Dual structuring	Topographic fragmentation	Urban symmetry
Micro Scale – Ambient Setting Sensorial Spatial Unit	Humidity-infused stone	Archetype of spa	Mild topography	Fountain vapor	Tactile layering	Blue-green textures	Steam dominance	Shaded treatment zones	Open-air exposure	Hydro-thermal node	Organic healing points	Ceremonial typologies
Intimate Scale – Experiential Detail Individual Perception	Sensory detachment	Ambient lightness	Diffuse circulation	Structured calm	Thermal seclusion	Symbolic watercourses	Water plastic	Clinical calm	Elemental stillness	Everyday therapeutic ritual	Melancholic facility	Interior tranquility
01 Brestovačka banja	02 Bukovička banja	03 Banja Kanjiža	04 Banja Koviljača	05 Ruzumlijska banja	06 Matarska banja	07 Niška banja	08 Ribarska banja	09 Banja Ruzanda	10 Sokobanja	11 Vranjska banja	12 Vrnjačka banja	

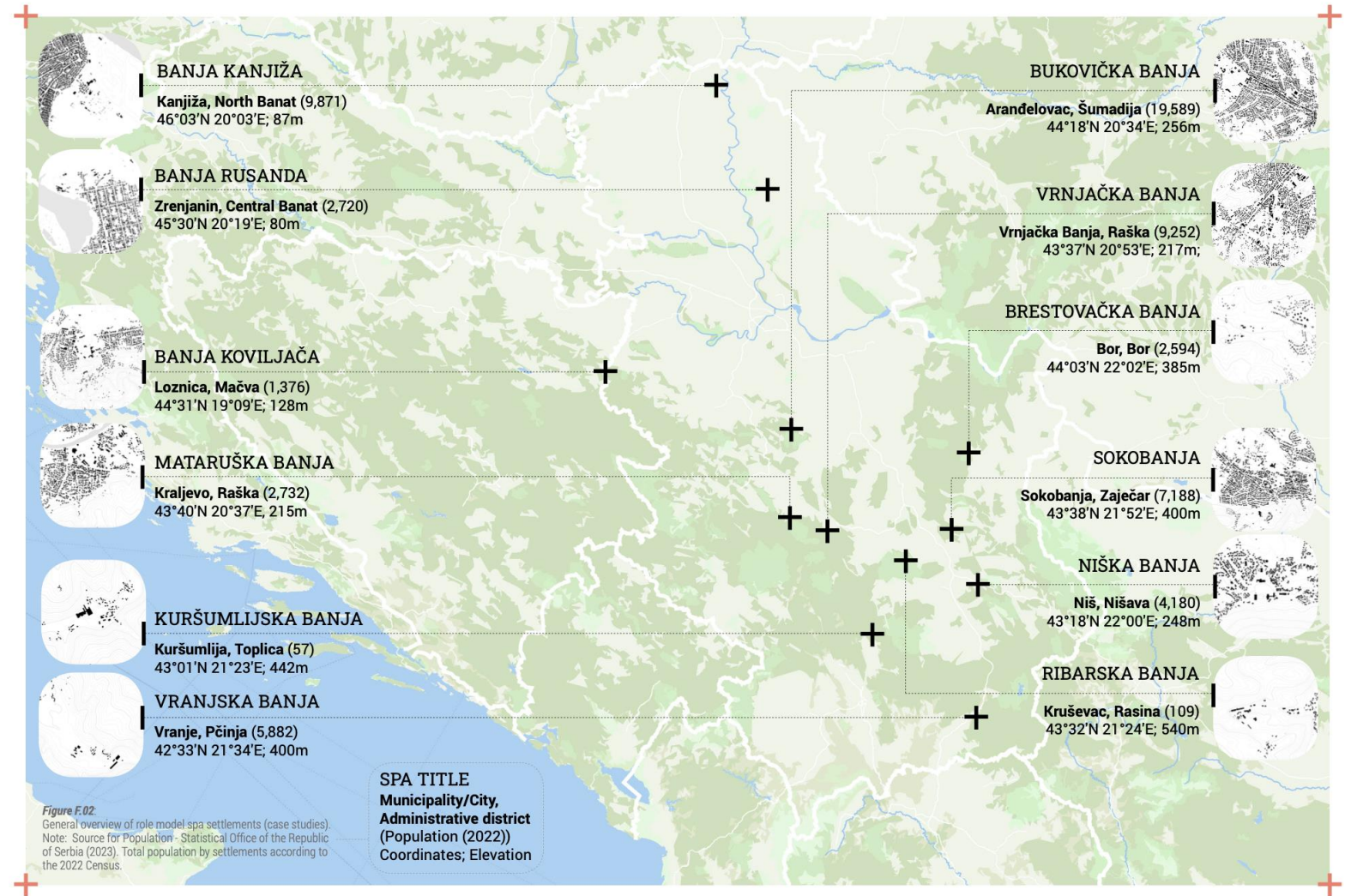

Figure F.02
General overview of role model spa settlements (case studies).
Note: Source for Population - Statistical Office of the Republic of Serbia (2023). Total population by settlements according to the 2022 Census.

01 HERITAGE REPROGRAMMING DESIGN APPROACH

Urban dimension.

- Historical trajectories
- Programming of spascapes

Landscape types.

Cultural-historical, Urban

Notion of heritage.

Heritage as **dynamic resource**,
reprogrammed for new uses while preserving
structure (adaptive reuse, continuity)

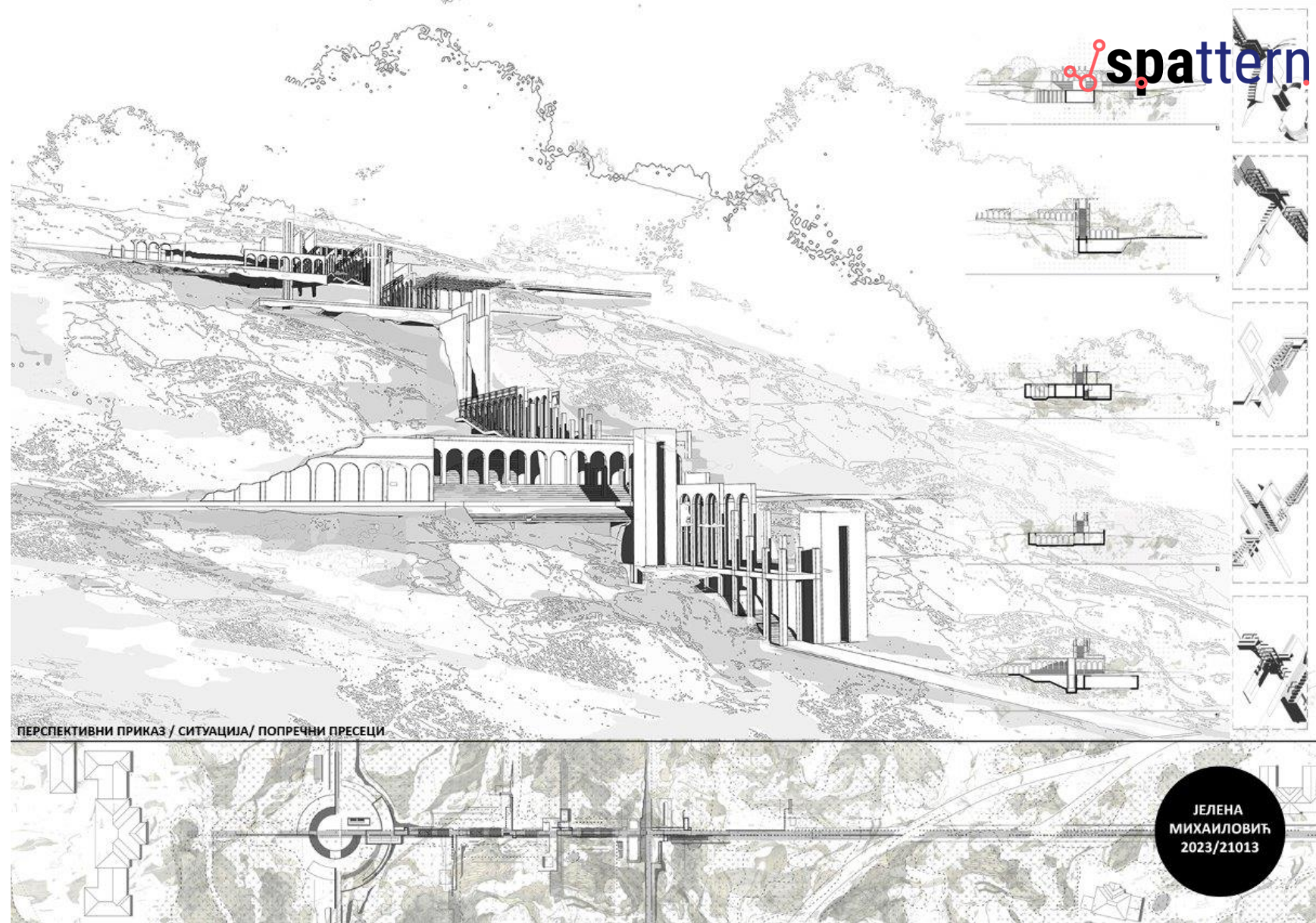

02 MULTISENSORY DESIGN

Urban dimension.

- Everyday life
- Public spaces in transformation

Landscape types.

Therapeutic, Recreational, Urban

Notion of heritage.

Heritage as **experiential environment**, valorized through sensory perception and inclusive design

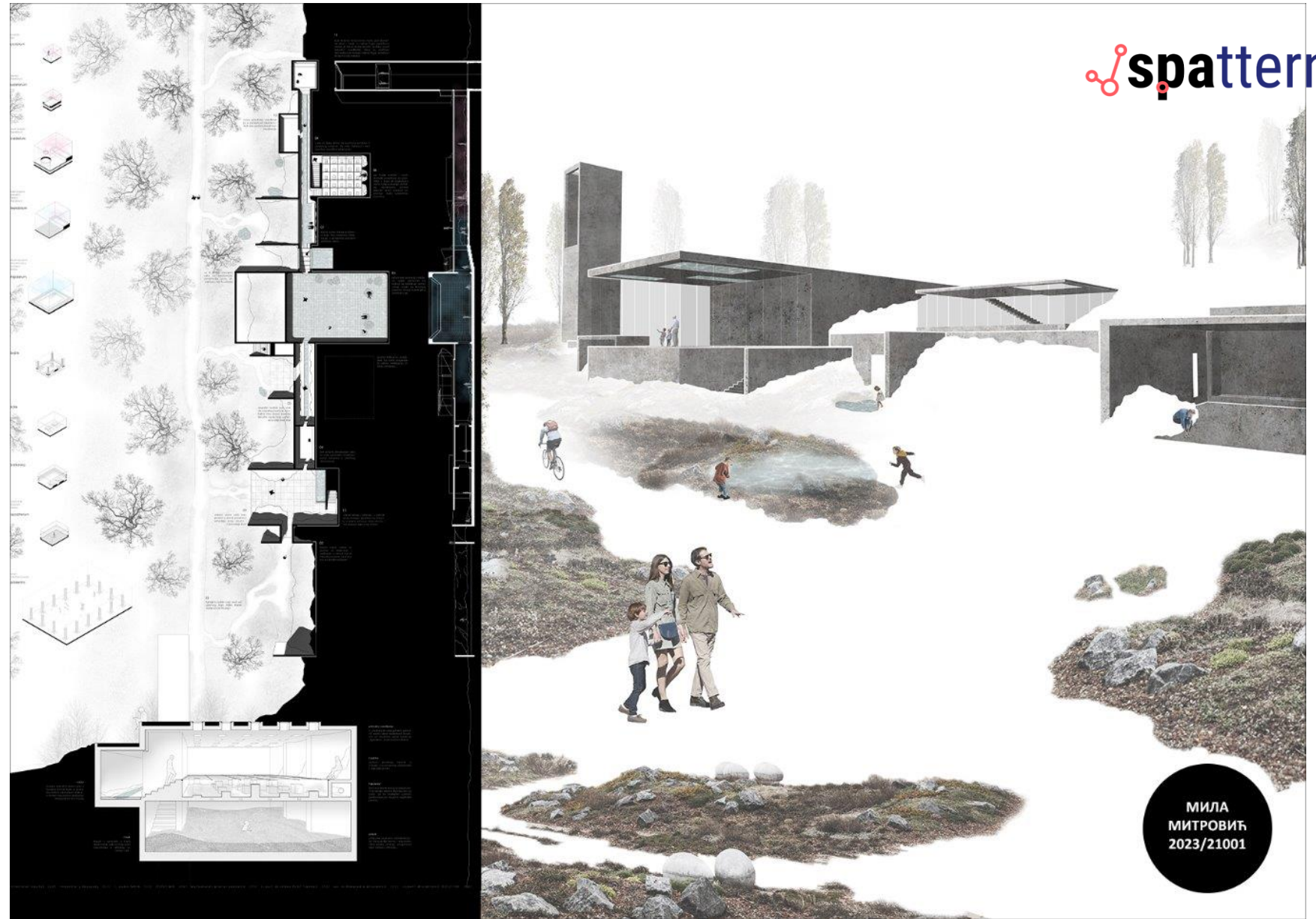

Anticipation

03 HEALTH PROMOTING DESIGN

Urban dimension.

- Therapeutic features
- Everyday life

Landscape types.

Hydrothermal, Therapeutic, Ecological

Notion of heritage.

Heritage as **health infrastructure**, integrated into spatial strategies for prevention, care, and well-being

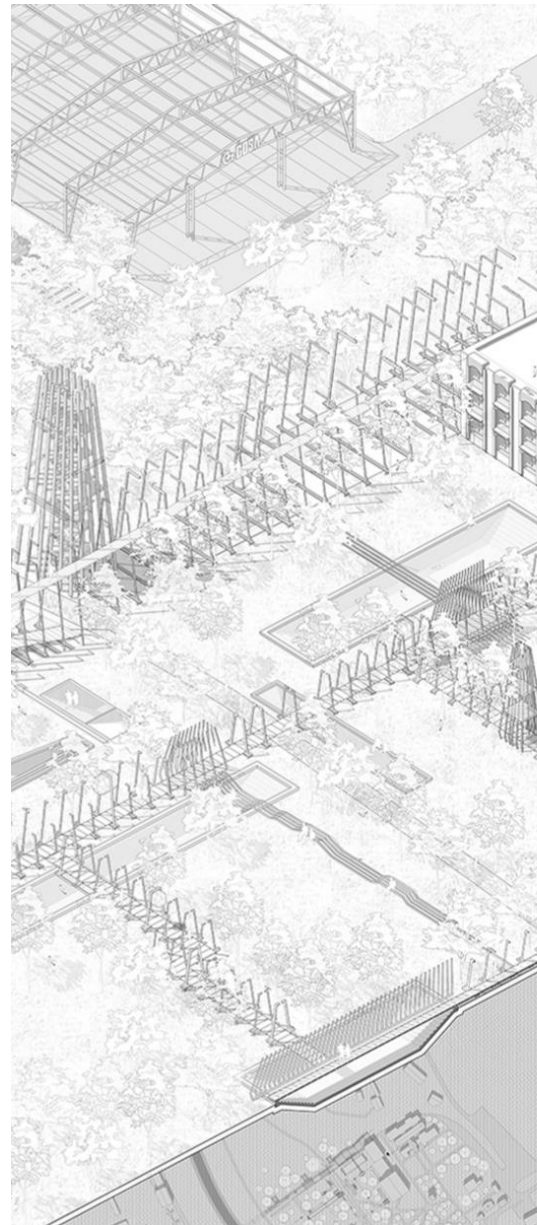

МАРИЈА
ЈОЦКОВИЋ
2023_21006

Anticipation

04

HYBRID NATURALITIES DESIGN APPROACH

Urban dimension.

- Naturescapes of urbanization
- Public spaces in transformation

Landscape types.

Ecological, Hydrothermal, Cultural-historical

Notion of heritage.

Heritage as **eco-techno system**, hybridizing natural and cultural flows (third nature)

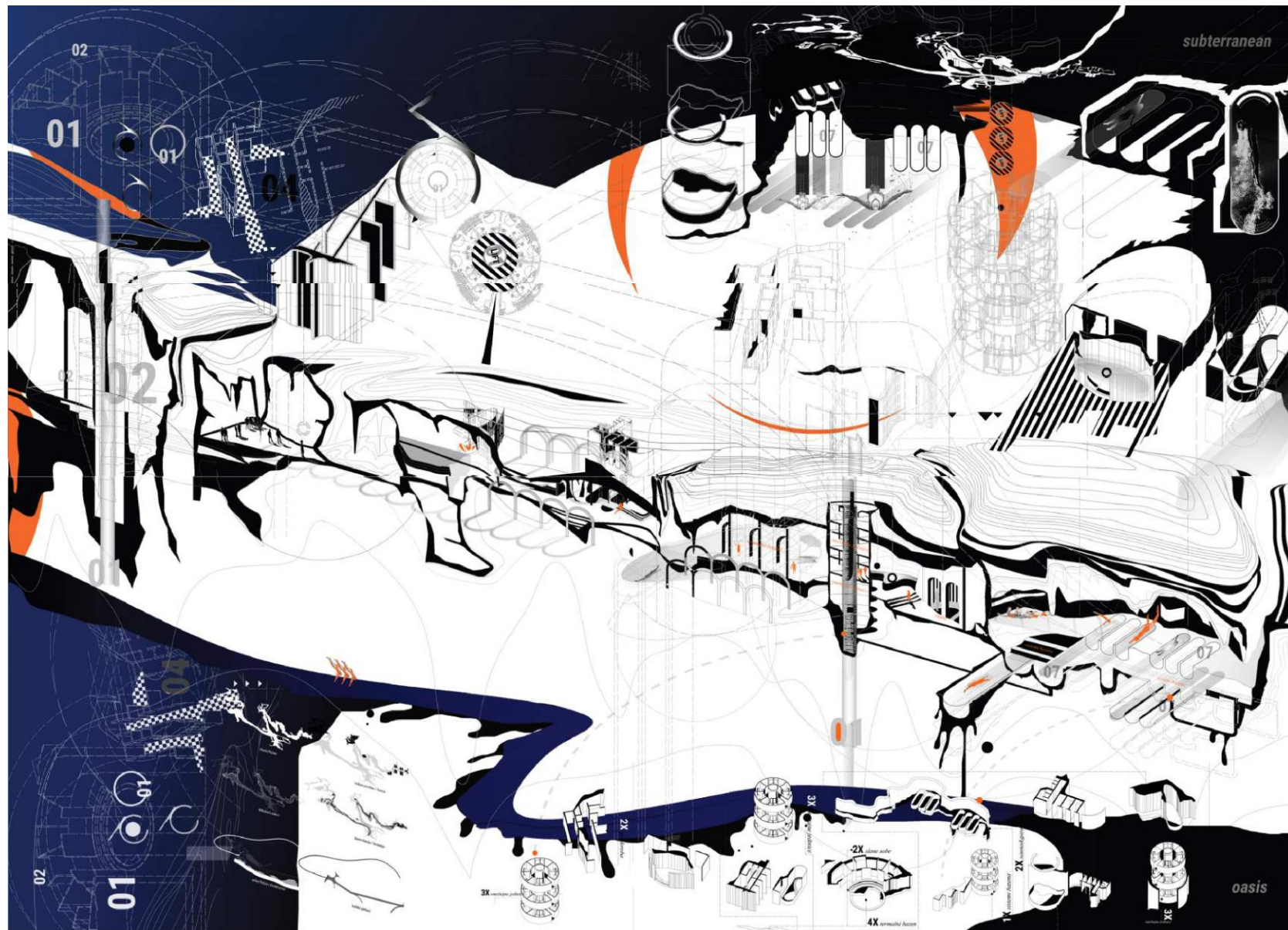

European Association for
Architectural Education
Association Européenne pour
l'Enseignement de l'Architecture

2025 EAAE Annual Conference – TRANSHISTORICAL PEDAGOGIES

Фонд за науку
Републике Србије



Anticipation



05 CULTURE SENSITIVE DESIGN

Urban dimension.

- Everyday life
- Historical trajectories

Landscape types.

Cultural-historical, Urban, Recreational

Notion of heritage.

Heritage as **carrier of local identity**, preserved through participatory and culturally embedded design

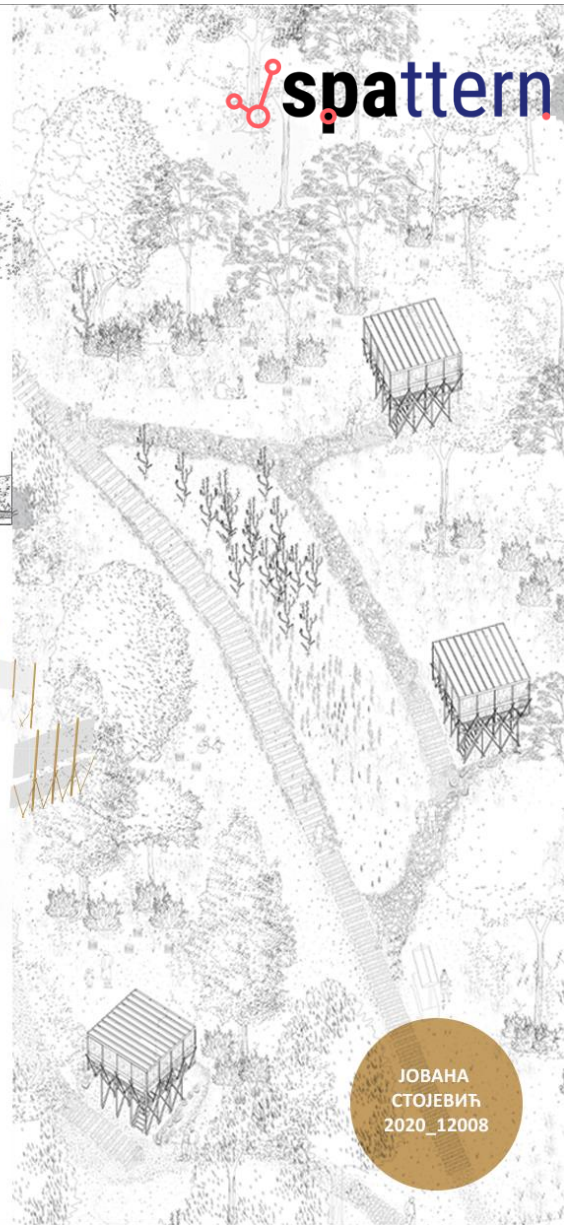
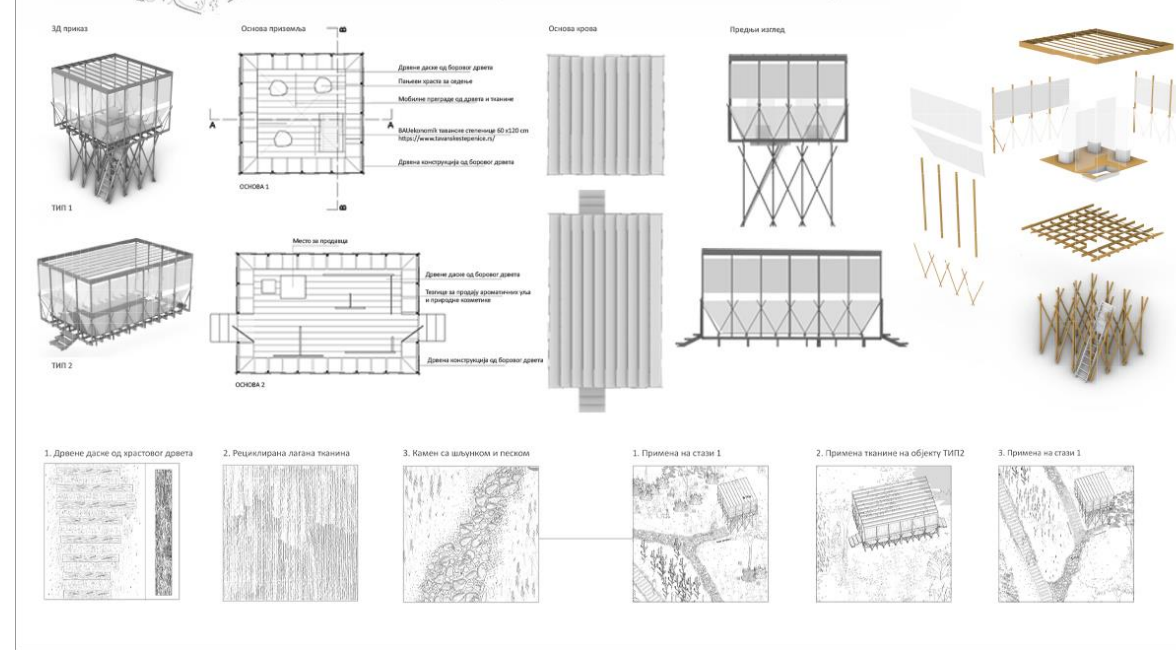

Anticipation

06 SPECULATIVE HERITAGE DESIGN

Urban dimension.

- Historical trajectories
- Naturescapes of urbanization

Landscape types.

Urban, Cultural-historical, Ecological

Notion of heritage.

Heritage as **open, anticipatory category**, critically redefined through speculative mapping and imaginaries

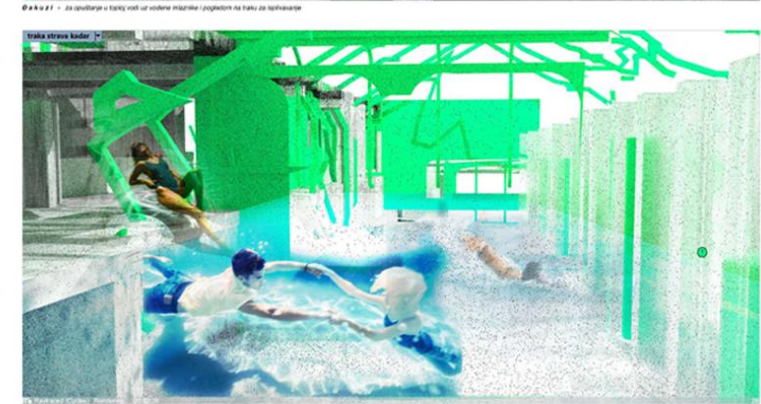
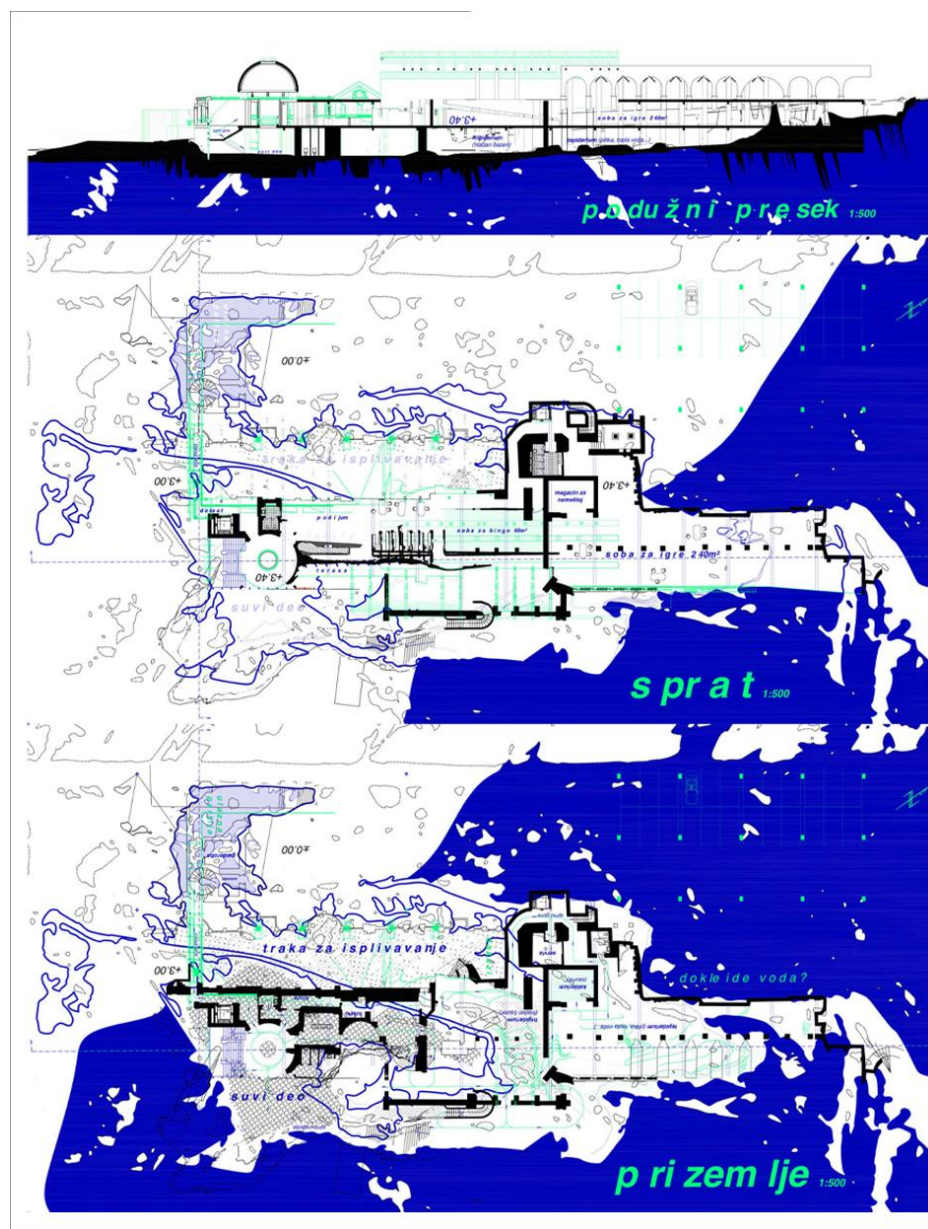

ДАМЈАН
ТРИФУНОВИЋ
2019/12023

Anticipation

Approach	Pedagogical Focus	Design Scale	Temporal Perspective	Innovation Type	Heritage Notion	Future Potential in Pedagogy
HERITAGE REPROGRAMMING	Adaptive reuse, continuity	Building / Urban core	Past–Present	Programmatic, typological	Heritage as dynamic resource	Can evolve into methodologies for long-term adaptability and interdisciplinary curricula on reuse and circularity.
MULTISENSORY DESIGN	Embodied experience, inclusivity	Spatial / Environmental	Present	Experiential, inclusive	Heritage as living environment	Can expand toward inclusive pedagogies addressing accessibility, aging, and diversity in architectural education.
HEALTH PROMOTING DESIGN	Health, prevention, well-being	Urban / Territorial	Present–Future	Infrastructural, systemic	Heritage as health infrastructure	Potential for cross-sector curricula connecting architecture, urbanism, and public health.
HYBRID NATURALITIES	Ecology & technology, “third nature”	Landscape / Territorial	Present–Future	Eco-techno, systemic	Heritage as hybrid eco-techno system	Opens pathways for eco-techno experimental studios and climate-responsive pedagogies .
CULTURE SENSITIVE DESIGN	Local identity, cultural rootedness	Urban / Social space	Past–Present	Participatory, cultural	Heritage as carrier of local identity	Can grow into models of participatory education , strengthening community-based and co-creative teaching.
SPECULATIVE HERITAGE	Critical imagination, futures	Urban / Landscape	Future	Speculative, visionary	Heritage as open anticipatory category	Can lead to pedagogies of anticipation — studios on futures thinking, uncertainty, and speculative design

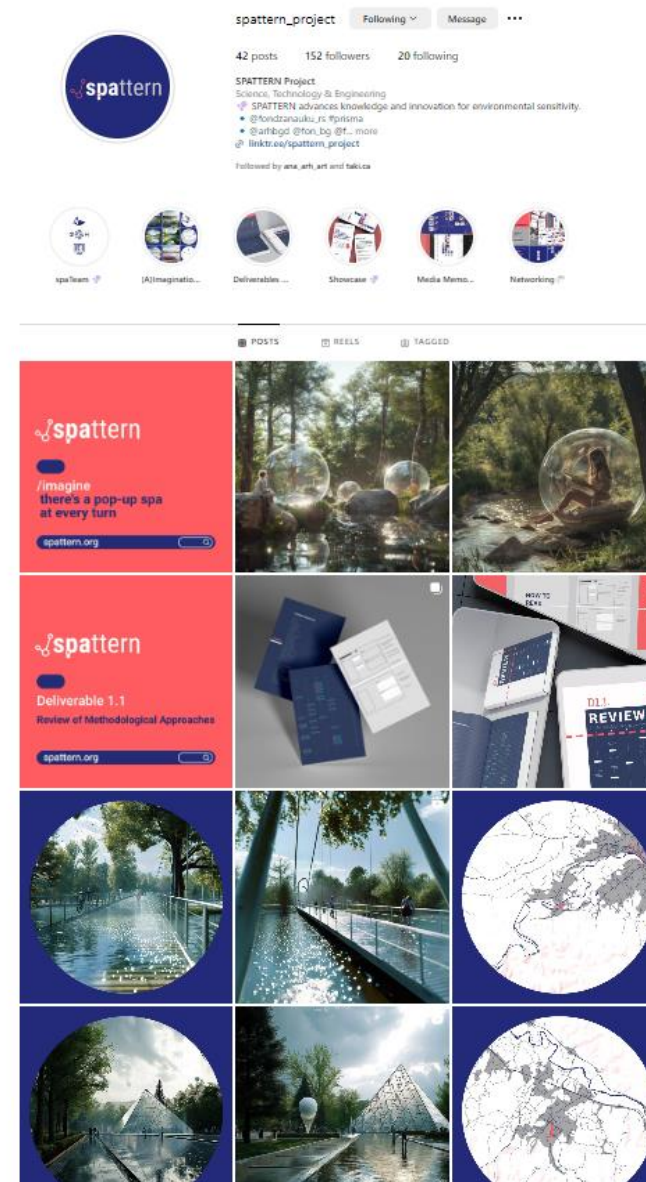

Funding

This research was supported by the Science Fund of the Republic of Serbia, Grant No. 7408, Future Heritage of Spa Settlements: Digital Platform for Advancing Knowledge and Innovation in Urban Morphology Approach for Environmentally Sensitive Development in Serbia—SPATTERN (<https://spattern.org/>).